



---

# CATERPILLAR 3406E, C13, C15, C16, C18 KIT INSTRUCTIONS

---

PN: 437-6562-50

**Note: This Kit is to “Remove & Install” the Caterpillar 3406E, C13, C15, C16 & C18 “Stainless Steel Injector Sleeves” with a “Threaded inside Diameter” as shown:**



## CATERPILLAR 3406E, C13, C15, C16 & C18 TOOLING INSTRUCTIONS



Sleeve pictured above without o-rings



## CATERPILLAR 3406E, C13, C15, C16 & C18 TOOLING INSTRUCTIONS

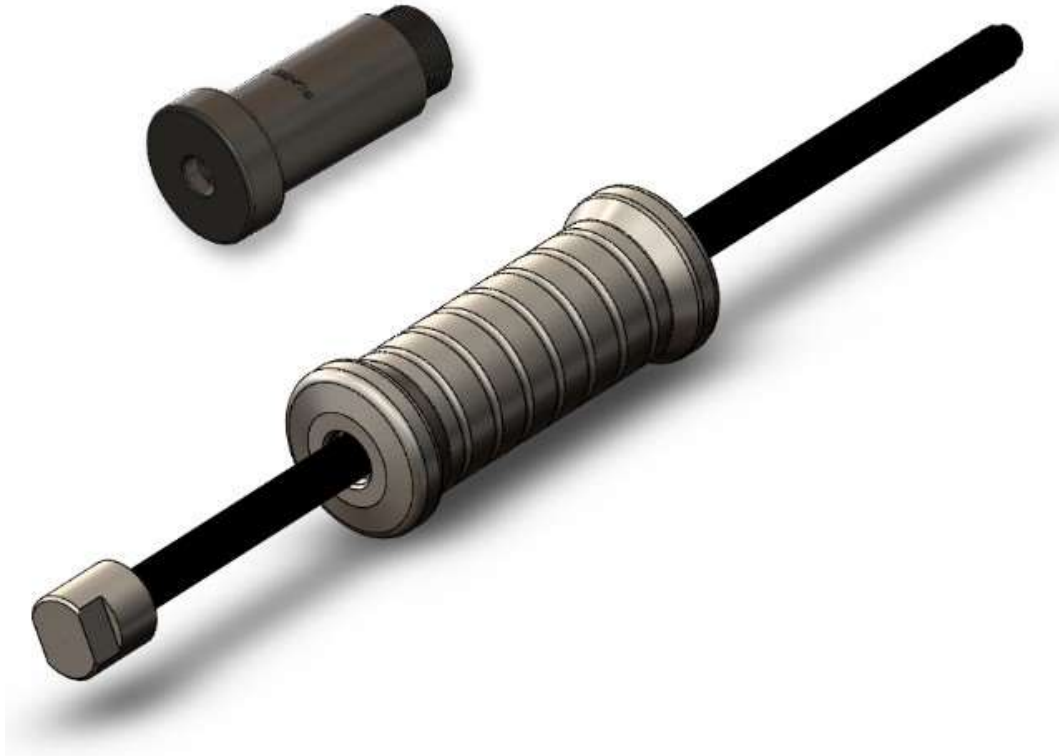

### 437-6562-50 - The Complete 3406E, C13, C15, C16, C18 Tooling

Above Kit includes the following:

IMAGE #	DESCRIPTION	PART #
1	Removal/Installation Tool Body	437-6562-49
2	Hammer Tool Assembly	437-6995-25



Made in the USA

Irontite Products Inc. – 2525 18<sup>th</sup> Street, Suite D, Cedar Rapids, IA 52404 USA  
800-423-3384 +1-319-377-9421 319-377-9101

## CATERPILLAR 3406E, C13, C15, C16 & C18 TOOLING INSTRUCTIONS

### Removal & Installation

#### Removal of old Injector Sleeve:

1. Thread Hammer Tool Assembly (437-6995-25) into Installation Tool (437-6562-49)
2. Now thread the large threaded end of the installation/removal tool into the injector sleeve. (Be sure to engage enough threads [2 to 3 at least])
3. With strong blows of the Hammer (usually 2-3), away from the casting, the injector sleeve will dislodge from the casting.

**Note:** Most shops reuse these heavy duty stainless steel injector sleeves, only replacing O-rings. Injector Sleeves should be inspected for damage & replaced if needed.

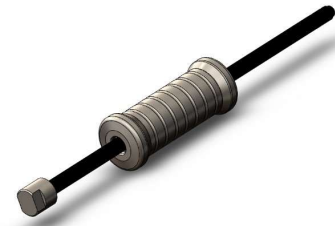

( 437-6995-25 )



( 437-6562-49 )

#### Installation of the new Injector Sleeve:

1. Clean the casting area in preparation of sleeve insertion.
2. Install new O-rings and use clean engine oil to lubricate "O" ring seals on a usable injector sleeve.
3. Thread the injector sleeve fully onto the large threaded end of the Installation/removal Tool that is already threaded onto the Hammer Tool Assembly.
4. Gently push the assembly with injector sleeve into the casting to get it pre-seated in the injector bore.
5. Using the Hammer, with strong downward blows (usually 2-3) toward the casting to seat the injector sleeve into the casting.





**Irontite Products Inc.**  
2525 18<sup>th</sup> Street SW, Suite D, Cedar Rapids, IA 52404 USA  
**800-423-3384**  
+1-319-377-9421  
FAX 319-377-9101  
**[www.irontite.com](http://www.irontite.com)**

Doc. PN: 451-3540-11 rev.230413